



Belinda Maherry
Candidate Property Practitioner
Registered with PPRA
(FFC 125 087 2)
0824427543

belindam@louwcoetzee.co.za



Mari Marais
Non-Principal Property Practitioner
Registered with PPRA
(FFC 105 514 7)
0829273248

marim@louwcoetzee.co.za

Contact Louw & Coetzee Properties

021 0003488

35 Main Road, Durbanville

2 Bedroom Apartment Sold in Stellenbosch Central

SOLD



SOLE MANDATE

Web Ref RL11612

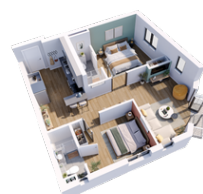

R4,025,000

Monthly Bond Repayment R41,545.58

Calculated over 20 years at 11% with no deposit.

Transfer Costs R286,424.00 **Bond Costs** R53,495.00

These calculations are only a guide. Please ask your conveyancer for exact calculations.

Monthly Levy R1,710



2



2

INVEST NOW | STELLENBOSCH UNIVERSITY CAMPUS

50% sold on pre-launch! Ideal investment opportunity with great rental yield and excellent location in Stellenbosch.

Lithops, a brand new, luxury apartment building in Stellenbosch, is ideally located right opposite the Engineering Faculty of Stellenbosch University. As the ideal student accommodation, residents will enjoy safety and convenience, with classes, restaurants, cafes, and other essential amenities all within a short walking distance from home.

This unit (Unit 8) is modern and stylish, offering 2-bedrooms, with vinyl flooring and quality finishes throughout, including 2 interior mood boards to choose from. The apartments consist of a fully fitted kitchen, bar seating for 2 people, a spacious living area, and the bedrooms including built-in cupboards, space for a desk, and en-suite bathroom for added privacy.

There...

Features

Interior

Bedrooms	2
Bathrooms	2
Kitchens	1
Recep. Rooms	1
Furnished	No

Exterior

Carports / Parkings	1
Security	Yes
Pool	No
Views	False

Sizes

Floor Size	58m ²
------------	------------------

Extras

24 Hour Access Secure Parking Communal Braai Area Quality Finishes On Campus Location

